

Miniature Rocker Switch

A8M

Miniature Rocker Switch for High Capacity Switching

- Miniature size with High current 16A switching.
- Easy to mount by snap fitting.
- UL and cUL standard approved.
Conforms to EN standards.



RoHS Compliant

Caution
Refer to Precautions

Ordering Information

List of Models

Contact Form		SPST	DPST	Quantity per box
Color of caps and cases		Black	Black	
Marking on caps		A8MS-1162	A8MD-1162	100
		A8MS-1163	A8MD-1163	

Specifications

Ratings

Rated load	Non-inductive	Inductive	
	Resistive load	Inductive load	Motor load
125 VAC	16 A	16 A	10 A
250 VAC	16 A	16 A	10 A

- Note:**
1. The inductive load has a power factor of 0.7 minimum (AC).
 2. The motor load has an impulse current 6 times the normal current.
 3. The above ratings were tested under the following conditions:
 - (1) Ambient temperature: 20±2 °C
 - (2) Ambient humidity: 65±5 %RH
 - (3) Switching frequency: 7 times/min.

Approved Safety Standards

UL (UL1054/CSA C22.2 No. 55)

16A 125 VAC, 16A 250 VAC

VDE (EN61058-1)

16A 125 VAC, 16A 250 VAC

Note: Quick connect terminals are not in compliance with IEC standards.

Characteristics

Permissible operating frequency	Mechanical: 20 Operations / min max. Electrical: 7 Operations / min max.
Insulation resistance	100 MΩ min. (500 VDC)
Dielectric strength	2,000 VAC 50/60Hz, for 1min between terminals of the same polarity 4,000 VAC 50/60Hz, for 1min between terminal and case ground.
Vibration resistance	Malfunction: 10 to 55 Hz, 1.5-mm double amplitude
Shock resistance	Malfunction: 1,000 m/s ² max.
Durability	Mechanical: 50,000 operations min. Electrical: 10,000 operations min.
Ambient operating temperature	- 25 to +55 °C (at ambient humidity of 60 % max.) (with no icing or condensation)
Ambient operating humidity	25 to 85 %RH (at +15 to 35 °C)
Weight	4.5 g (SPST), 5.9 g (DPST)

Dimensions

A8MS-1162
A8MS-1163
A8MD-1162
A8MD-1163

- Note:** 1. All units are in millimeters unless otherwise indicated.
 2. The following illustrations and drawings are for 2 poles (DPST) models, 1 pole (SPST) models have single side terminals.
 3. Unless otherwise specified, a tolerance of ± 0.3 mm applies to all dimensions.

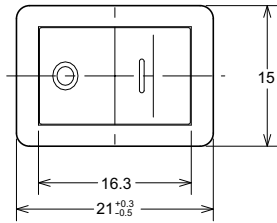
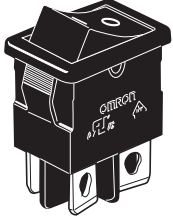

Operating Characteristics

No. of poles	1 (SPST)	2 (DPST)
Operating force (OF) max.	8 N {816 gf}	14 N {1,428 gf}

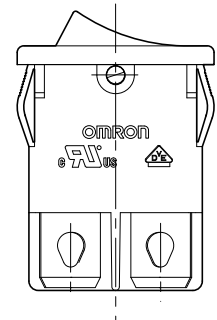
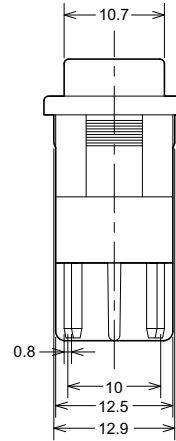
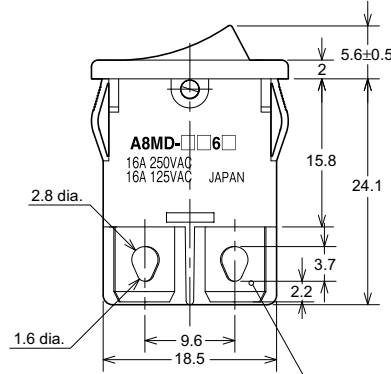

Solder Terminal

#250 Quick connect terminal (t=0.8) common use

Quick connect terminals are not in compliance with IEC standards.

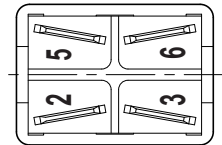

Panel Cutout

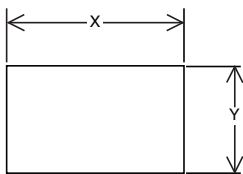

Panel thickness (mm)	X (mm)	Y (mm)
0.75 to 1.25	19.2 ^{+0.1} ₀	12.9 ^{+0.1} ₀
1.26 to 2.00	19.4 ^{+0.1} ₀	
2.01 to 3.00	19.8 ^{+0.1} ₀	

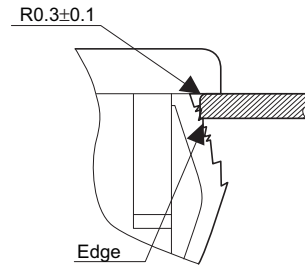

Be sure that play R or above-mentioned R is the operation side.

Precautions

Be sure to read the Safety precautions common to all Rocker Switches for correct use.

ALL DIMENSIONS SHOWN ARE IN MILLIMETERS.
 To convert millimeters into inches, multiply by 0.03937. To convert grams into ounces, multiply by 0.03527.